

Sources:

- Point2 Surveyors:
- Site Photos
- Point Cloud Data
- Ordnance Survey:
- OS Map
- Zmap

Simpson-Haugh and Partners:

Received 03/12/18

10061-Z0-G200-3-AL-Detailed Model.dwg

10106-A-DRG-Z0-G100-4000(0-3).dwg's Elevations

10106-A-DRG-Z0-G200-2000(00-31).dwg's Plans

Project: Kensington Forum Hotel

Scale: 1:1000

Drawn By: SA/CJ

Date: DEC 2018

Dwg No: **P813/**

249

Title: BRE 2 Hour Sunlight Test

Proposed Scheme 03/12/18

March 21st

Point 2 Surveyors Ltd,
3rd Floor
17 Slingsby Place,
London WC2E 9AB,
0207 836 5828
www.point2surveyors.com

POINT
surveyors

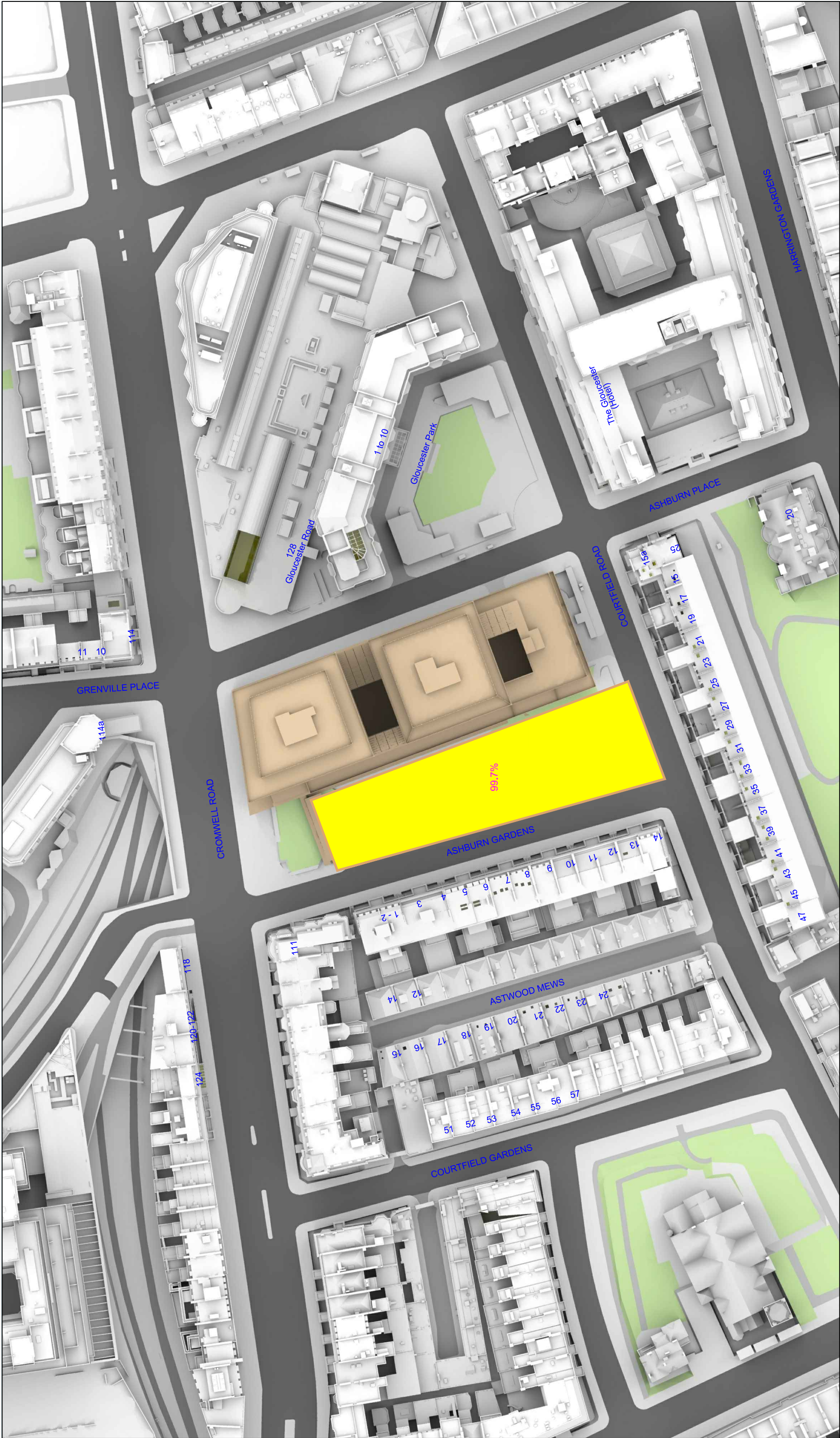

Sources: Point2 Surveyors:
Site Photos
Point Cloud Data

Ordnance Survey:
OS Map
Zmap

SimpsonHaugh and Partners:
Received 03/12/18
10061-Z0-G200-3-AL-Detailed Model.dwg
10106-A-DRG-Z0-G100-4000(0-3).dwg's Elevations
10106-A-DRG-Z0-G200-2000(00-31).dwg's Plans

Key: All the Heights in mm AOD

Proposed Scheme
Existing Buildings

AREA ANALYSED

AREA WITH MORE THAN 2 HOURS OF DIRECT SUNLIGHT
AREA WITH LESS THAN 2 HOURS OF DIRECT SUNLIGHT
% OF AREA WITH MORE THAN 2 HOURS OF DIRECT SUNLIGHT

Project: Kensington Forum Hotel

Project: BRE 2 Hour Sunlight Test
Proposed Scheme 03/12/18
June 21st

Drawn By: SA/CJ

Scale: 1:1000

Date: DEC 2018

Dwg No: **P813/**

250

Point 2 Surveyors Ltd,
3rd Floor
17 Slingsby Place,
London WC2E 9AB,
0207 836 5828
www.point2surveyors.com

POINT
surveyors

Transient without Trees

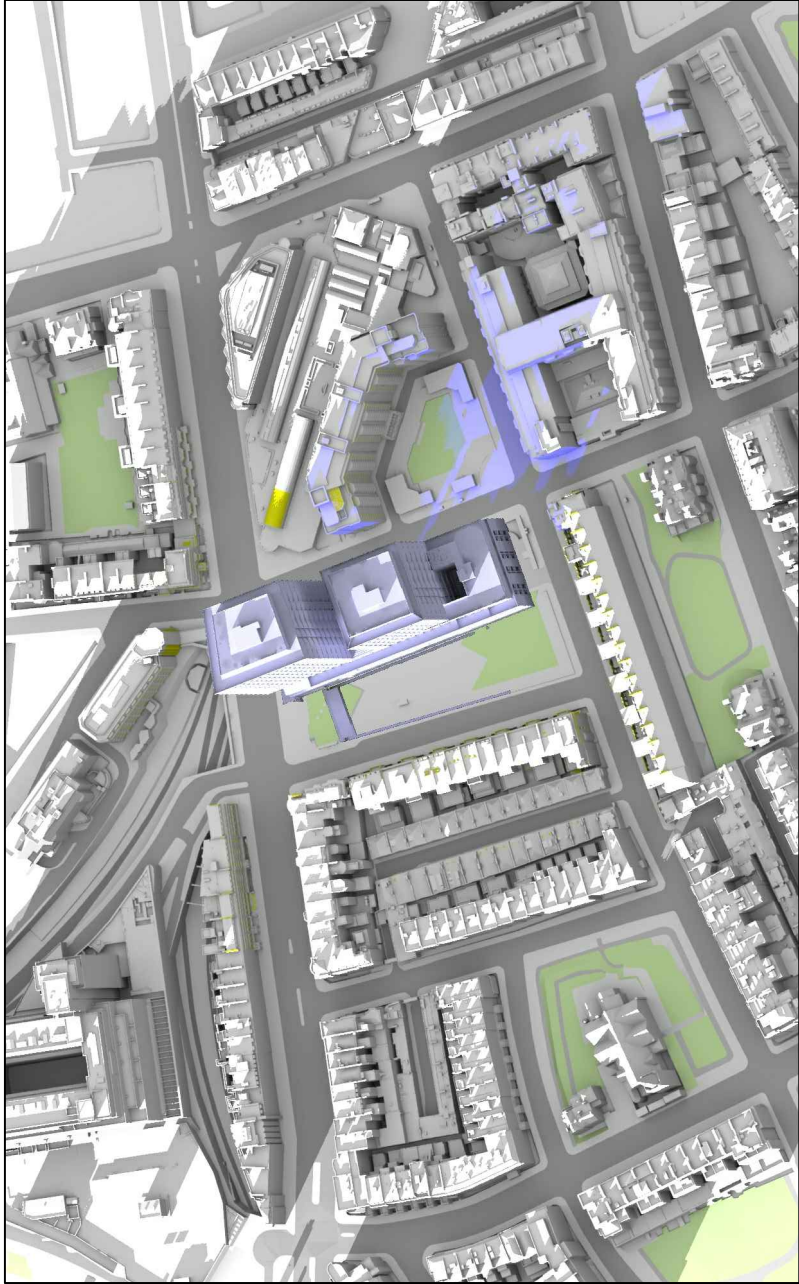

Existing 08:00pm

June 21st (BST)

Proposed 08:00pm

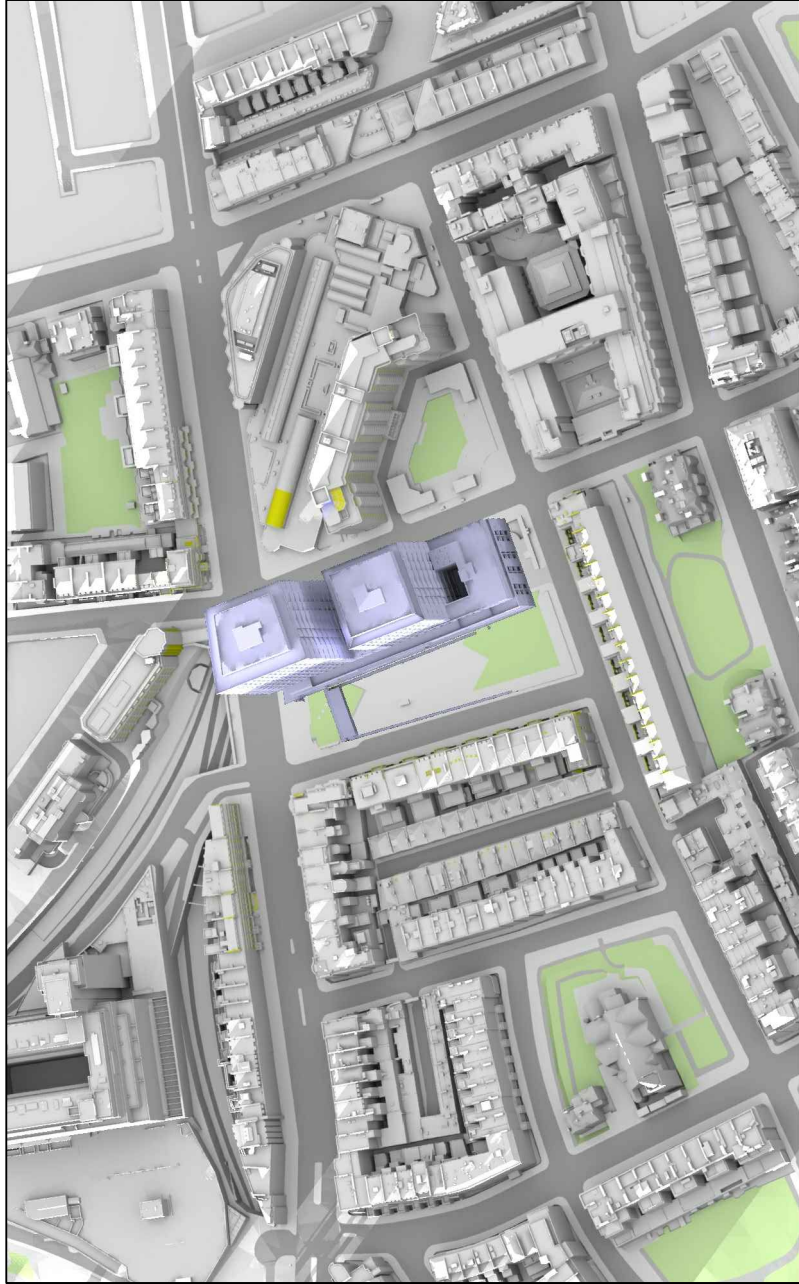
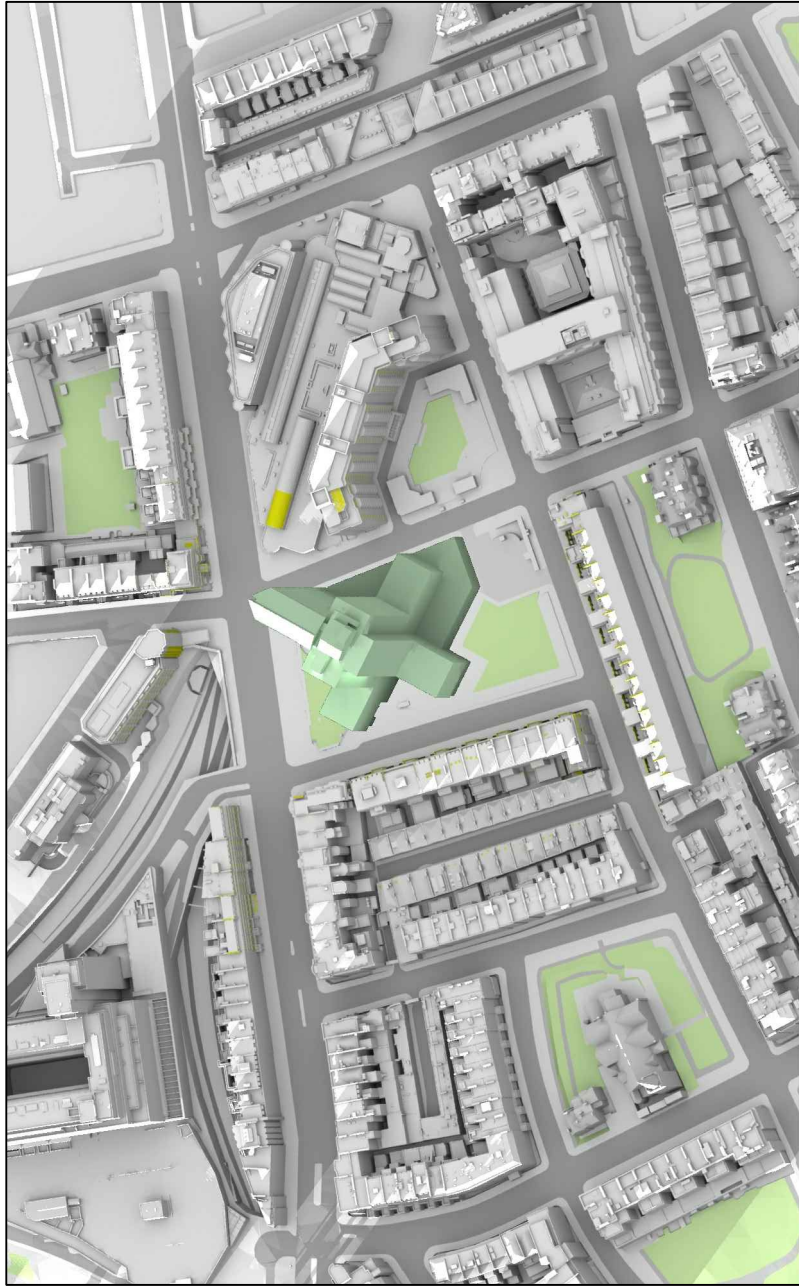

Existing 09:00pm

Proposed 09:00pm

Sources: Point2 Surveyors:
Site Photos
Point Cloud Data
Ordnance Survey:
OS Map
Zmap
SimpsonHaugh and Partners:
Received 03/12/18
10061-Z0-G200-3-AL-Detailed Model.dwg
10106-A-DRG-Z0-G100-4000(0-3).dwg's Elevations
10106-A-DRG-Z0-G200-2000(00-31).dwg's Plans

Key:

Grey shadows are those caused by buildings which are not on the site under development.

Green shadows are those caused specifically by the existing buildings on the site.

Blue shadows are those caused specifically by the proposed development.

Project: Kensington Forum Hotel

Title: Transient Overshadowing

Drawn By: SAC/J

Scale: NTS

Date: DEC 2018

Dwg No: **P813/ JUN1/08**

Point 2 Surveyors Ltd,
3rd Floor
17 Slingsby Place,
London WC2E 9AB,
0207 836 5828
www.point2surveyors.com



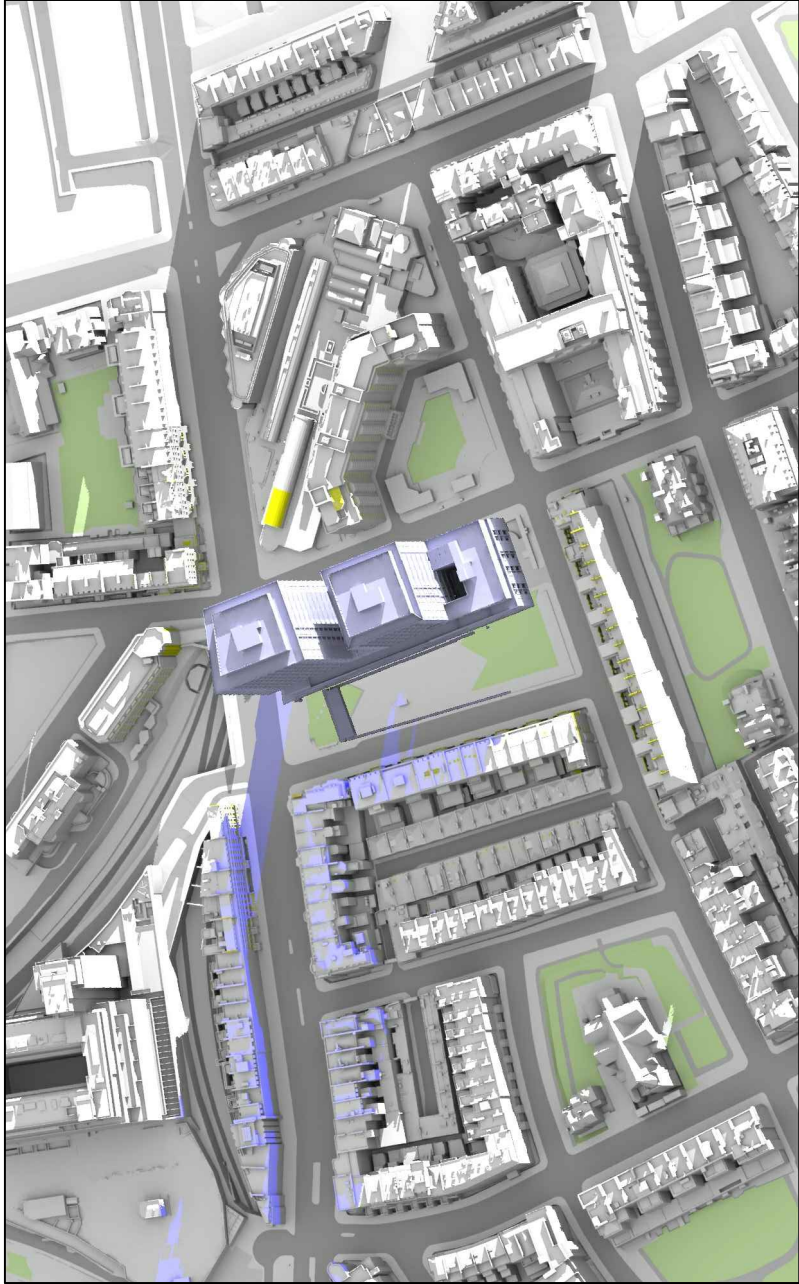
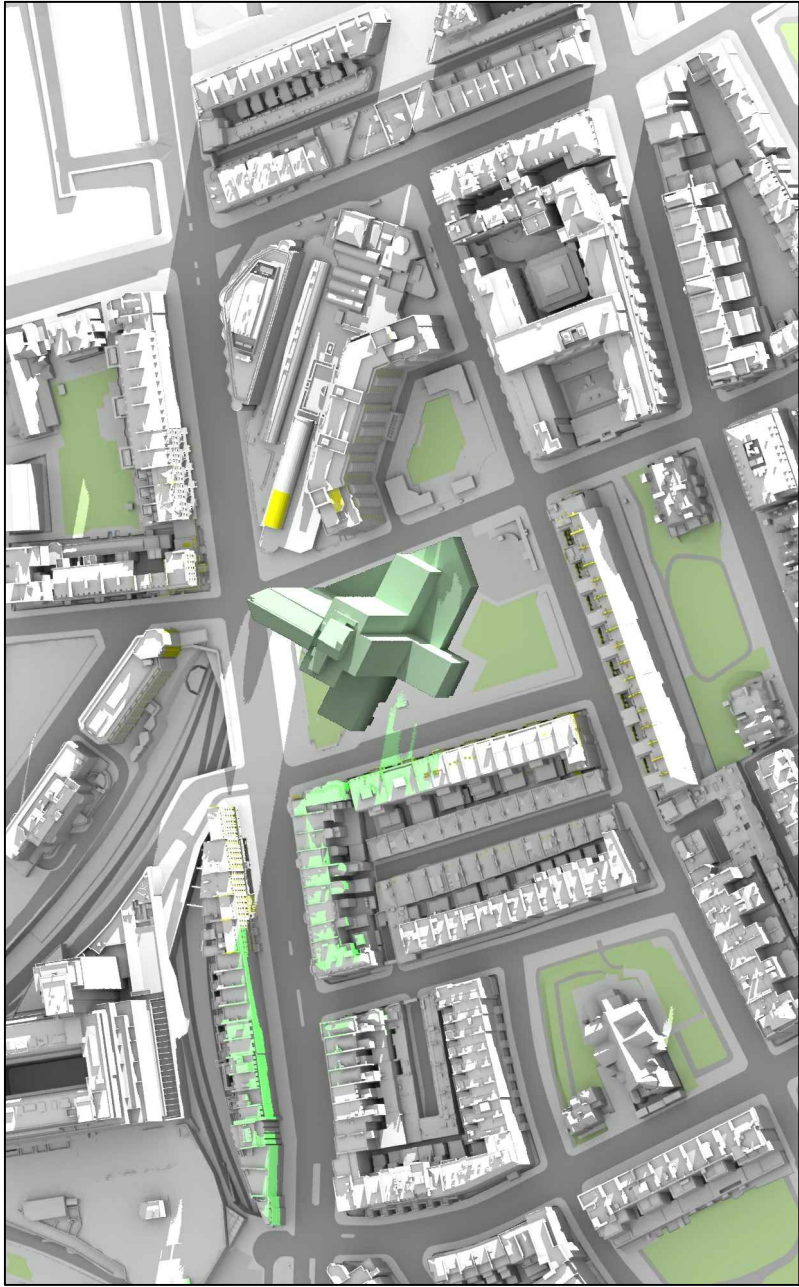

Existing 07:00am

March 21st (GMT)

Proposed 07:00am

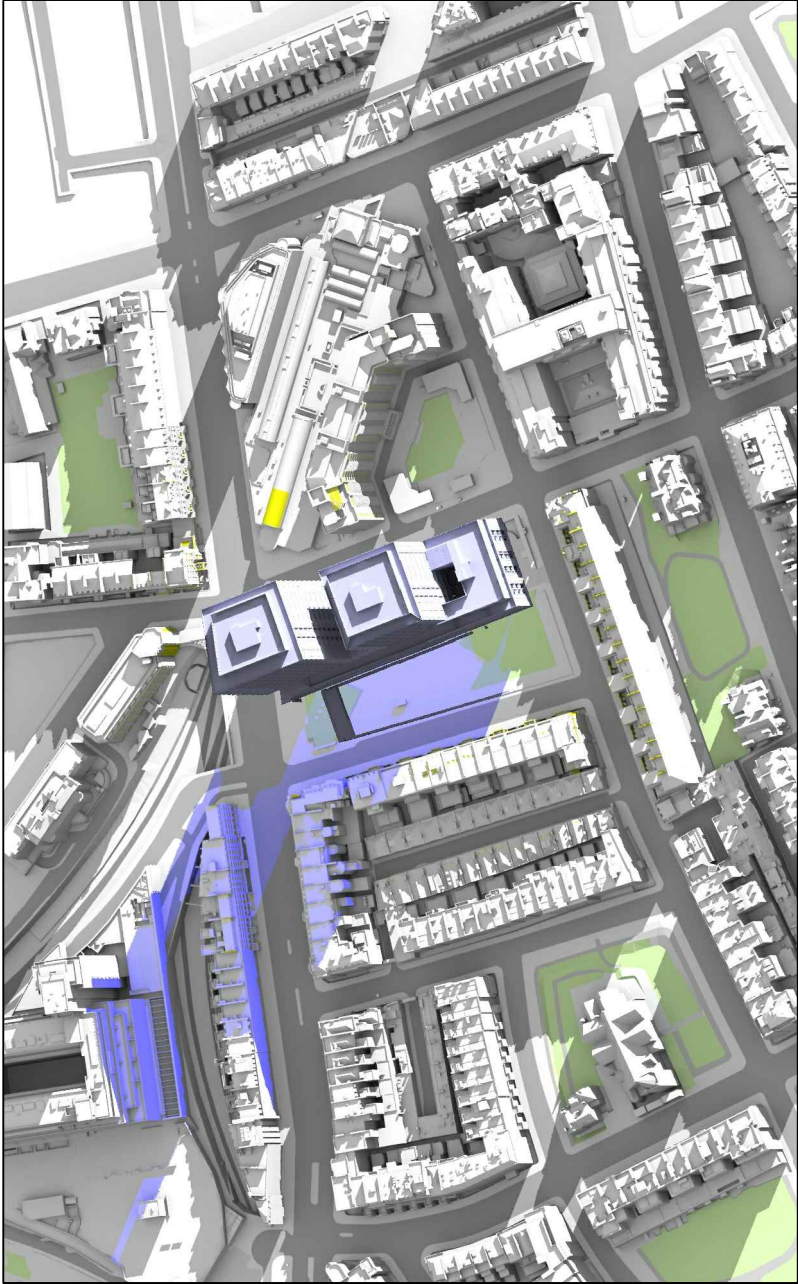
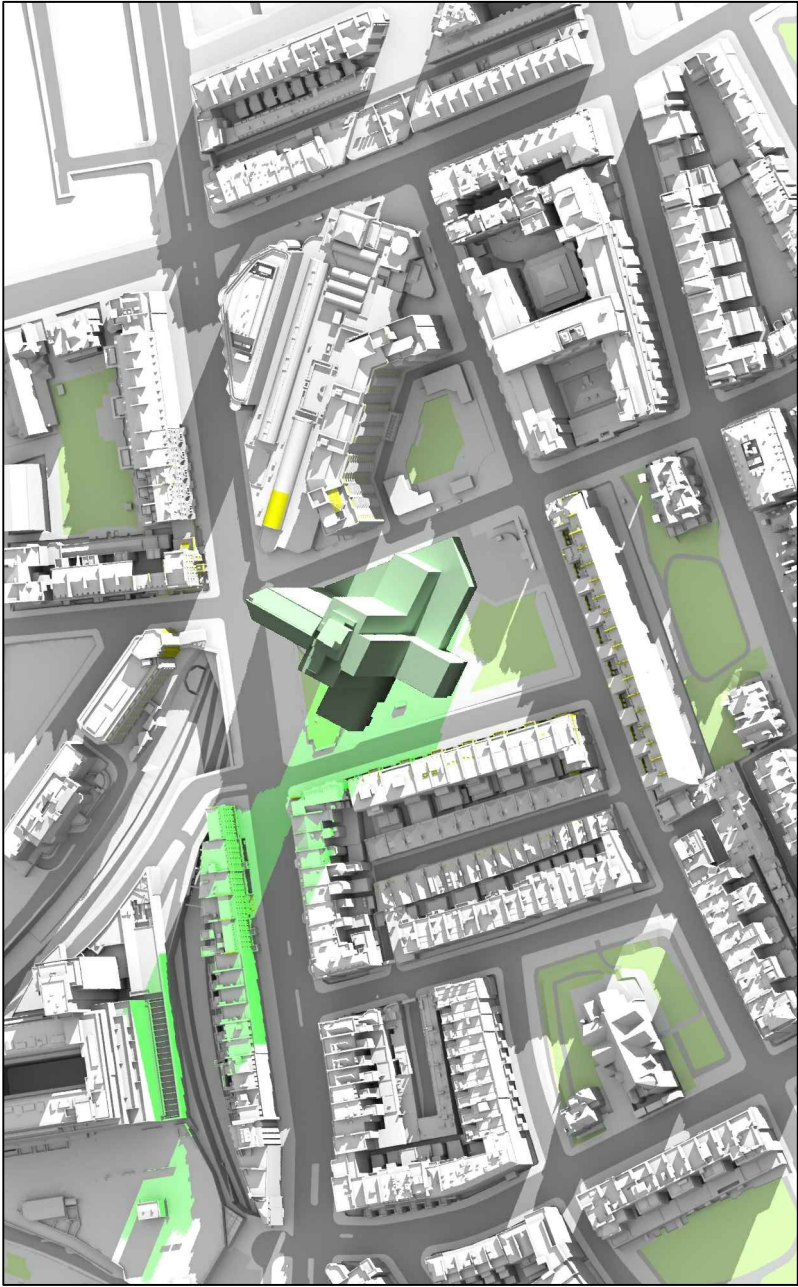

Existing 08:00am

Proposed 08:00am

Sources: Point2 Surveyors:
Site Photos
Point Cloud Data
Ordnance Survey:
OS Map
Zmap
SimpsonHaugh and Partners:
Received 03/12/18
10061-Z0-G200-3-AL-Detailed Model.dwg
10106-A-DRG-Z0-G100-4000(0-3).dwg's Elevations
10106-A-DRG-Z0-G200-2000(00-31).dwg's Plans

Key:

Grey shadows are those caused by buildings which are not on the site under development.

Green shadows are those caused specifically by the existing buildings on the site.

Blue shadows are those caused specifically by the proposed development.

Project: Kensington Forum Hotel

Title: Transient Overshadowing

Drawn By: SA/CJ

Scale: NTS

Date: DEC 2018

Dwg No: **P813/ MAR1/01**

Point 2 Surveyors Ltd,
3rd Floor
17 Slingsby Place,
London WC2E 9AB,
0207 836 5828
www.point2surveyors.com

